

# STEERING WHEEL

< SERVICE INFORMATION >

## STEERING WHEEL

### On Board Inspection and Service

INFOID:00000004718109

#### PLAY INSPECTION

1. Turn steering wheel to the straight-ahead position. Start engine and lightly turn steering wheel clockwise and counterclockwise until the front wheels start moving. Measure the travel to the starting point on the circumference of steering wheel. If play is outside the specified range, check steering gear assembly, front suspension, axles, and steering column for proper installation.

**Steering wheel play inspection standard : 0 - 35 mm (0 - 1.38 in)**

2. Check steering wheel for vertical, horizontal, or axial play.

**Steering wheel axial end play : 0 mm (0 in)**

- Lift vehicle and check steering gear nuts and bolts for looseness.

**Tightening torque : 94 N·m (9.6 kg-m, 69 ft-lb)**

#### NEUTRAL POSITION INSPECTION

- After wheel alignment inspection, perform neutral position inspection. Refer to [FSU-7, "Wheel Alignment"](#).
- Set vehicle to the straight-ahead position and confirm steering wheel is in the neutral position.
- If it is not in the neutral position, loosen lock nut on tie-rod. Then adjust until the amount of left and right becomes equal.

#### STEERING TORQUE INSPECTION

1. Stop vehicle on a dry flat paved road and apply parking brake.
2. Remove air bag module. Refer to [SRS-33](#).
3. Start engine and use a preload gauge (SST) to check steering wheel torque.

**Steering torque : 5.9 N·m (0.60 kg-m, 52 in-lb) or less**

4. When torque is outside the standard, check steering column and steering gear. If any non-standard condition is detected, replace if necessary.

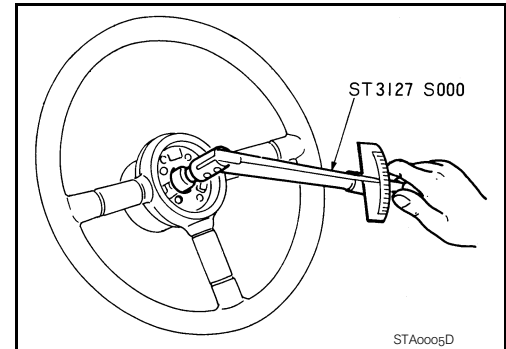

#### STEERING ANGLE INSPECTION

- After toe-in inspection, check the steering angle. Place the front wheels on turning radius gauges and the rear wheels on stands so that the vehicle can be level. Check the maximum inner and outer wheel steering angles for LH and RH road wheels.

