

# GLOVE BOX ASSEMBLY

## GLOVE BOX ASSEMBLY

PFP:68510

### Removal And Installation REMOVAL

BIS0014W

1. Remove the glove box assembly. Refer to [IP-9, "Q. Glove Box Cover Assembly"](#).

### INSTALLATION

Install in the reverse order of removal.

### Disassembly And Assembly

BIS0014X

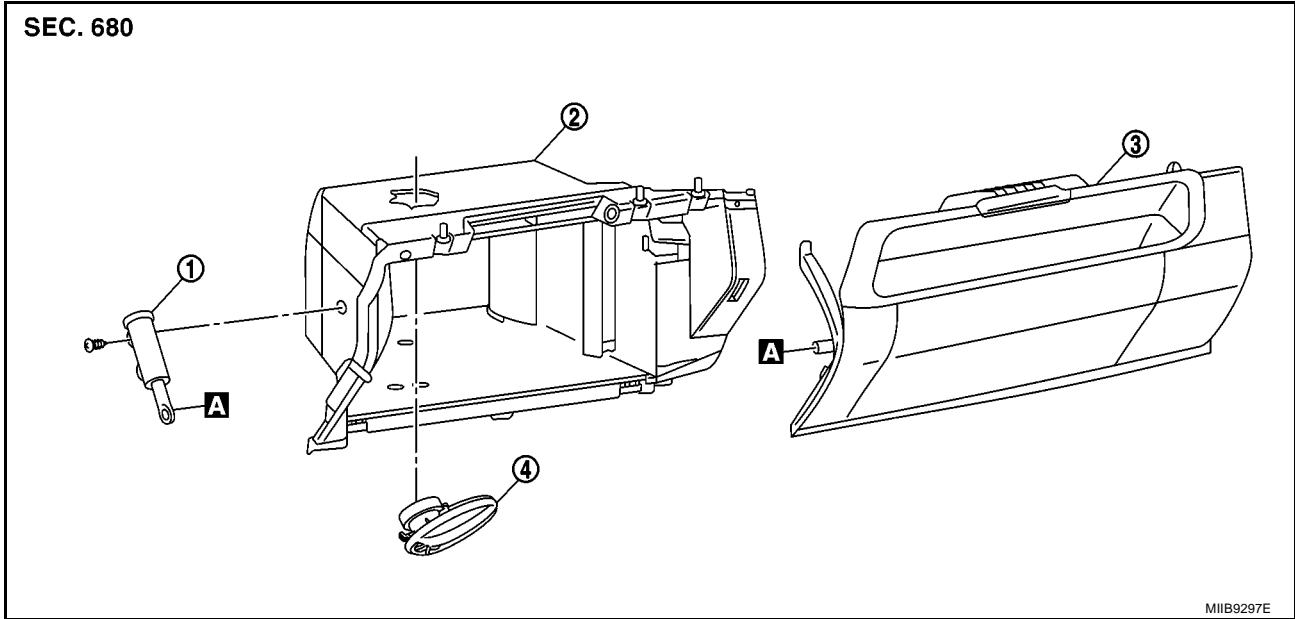

1. Spring assembly
2. Glove box cover
3. Glove box lid
4. Air conditioner inlet

### DISASSEMBLY

1. Remove spring assembly screw.
2. Push glove box lid hooks to disengage glove box lid from the glove box cover.
3. Remove the air conditioner inlet from the glove box cover.

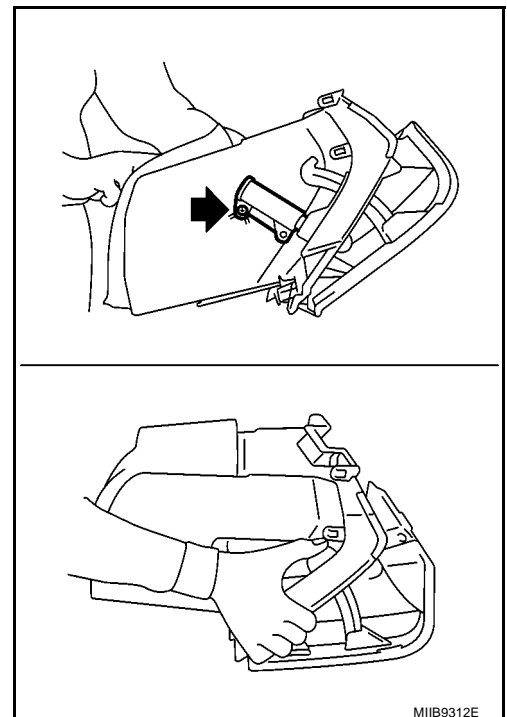

### ASSEMBLY

Assembly is in the reverse order of disassembly.